

**Standard Construction and Materials**

**FRAME:** ¼" aluminum plate.

**BLADE:** ¼" structural aluminum angle.

**FRAME DEPTH:** 5½" deep

**SCREEN:** ½" x 0.051" expanded aluminum

**FREE AREA:** 49.3% - 7.89 sq. ft. (48" x 48" Louver)

**PSF RATING:** 266 PSF Design Load

**TEST METHODS:** ICC 500, FEMA 361, ASTM E 330, ASTM E 1886

**AVAILABLE FINISHES:** Mill, Kynar

**Test Methods**

**ICC 500-2014**, Standard for the Design and Construction of Storm Shelters.

**FEMA 361 3rd Edition**, Section B8 Test Methods for Impact and Pressure Testing.

**ASTM E 330-02**, Test Method for Structural Performance of Windows, Curtain Walls and Doors by Uniform Static Air Pressure Difference.

**ASTM E 1886-05**, Standard Test Method for Performance of Exterior Windows, Curtain Walls, Doors, and Impact Protective Systems Impacted by Missile and Exposed to Cyclic Pressure Differentials.

**Notes**

1. Nominal deductions will be made to the opening size given.
2. Keep occupants and mechanical equipment to a minimum of 3 feet away from the louver during severe weather events.
3. Approximate shipping weight is 15.0 lbs./sq.ft.

**Louver Sizes**

Min Panel	Max Single Panel
12"W x 12"H	90"W x 90"H (Continuous Wide) 78"W x 90"H (Continuous High)

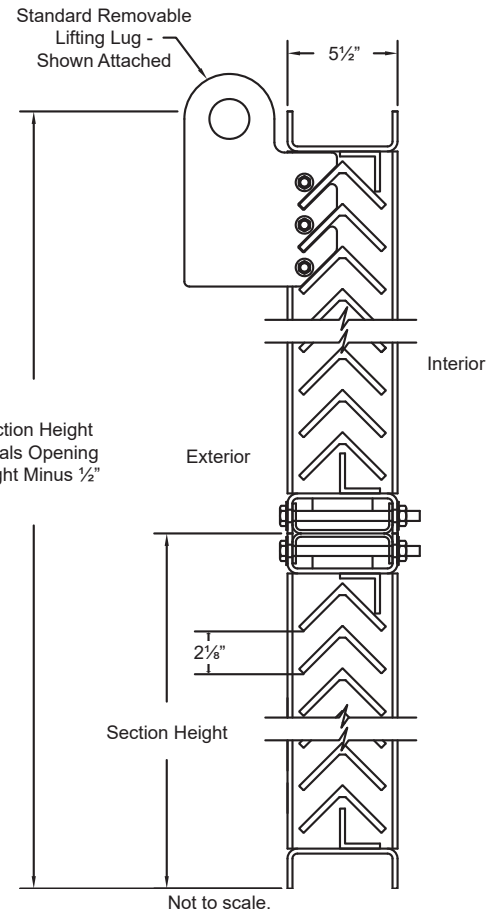

Standard Mount

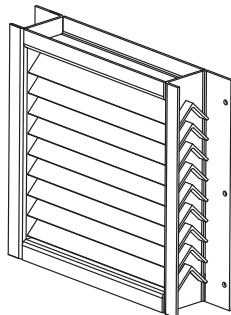

Cantilevered Mount  
Flange at Jamb

Optional Flange Mounting or Channel Frame Mounting

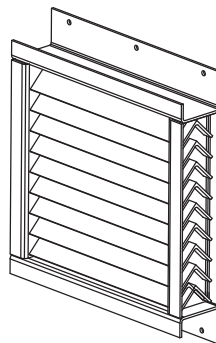

Cantilevered Mount  
Flange at Head & Sill

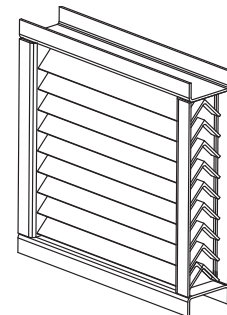

Recessed Mount  
Channel Frame

Item #	Qty	Width	Height	Width	Height	Mullion	Type	Location		
		Opening Size		Louver Size			Screens			Union Made
Arch. / Eng.:						EDR:		ECN:		Job:
Contractor:										
Project:						Date:		DWN:		DWG:

In the interest of product development, Cesco Products reserves the right to make changes without notice.



450 Riverside Dr • Wyalusing PA, 18853  
Phone: 570-746-1888 • Fax: 570-746-9286  
www.cescoproducts.com

Performance Data

		Free Area sq.ft. (sq.m.)								
		Width in. (mm)								
		12" (305)	24" (610)	36" (914)	48" (1219)	60" (1524)	72" (1829)	78" (1981)	84" (2134)	90" (2286)
Height in. (mm)	12" (305)	0.23 (0.021)	0.79 (0.073)	1.34 (0.124)	1.88 (0.175)	2.44 (0.277)	2.99 (0.278)	3.26 (0.303)	3.53 (0.328)	3.72 (0.345)
	24" (610)	0.47 (0.043)	1.63 (0.152)	2.76 (0.256)	3.88 (0.361)	5.05 (0.469)	6.18 (0.574)	6.74 (0.626)	7.30 (0.678)	7.68 (0.714)
	36" (914)	0.71 (0.066)	2.48 (0.230)	4.18 (0.389)	5.89 (0.547)	7.66 (0.711)	9.36 (0.870)	10.22 (0.949)	11.07 (1.028)	11.65 (1.082)
	48" (1219)	0.95 (0.088)	3.32 (0.308)	5.61 (0.521)	7.89 (0.733)	10.26 (0.953)	12.55 (1.166)	13.69 (1.272)	14.84 (1.378)	15.61 (1.450)
	60" (1524)	1.19 (0.111)	4.16 (0.387)	7.03 (0.653)	9.90 (0.920)	12.87 (1.196)	15.74 (1.462)	17.17 (1.595)	18.61 (1.728)	19.58 (1.819)
	72" (1829)	1.43 (0.133)	5.01 (0.465)	8.46 (0.786)	11.90 (1.106)	15.48 (1.438)	18.93 (1.758)	20.65 (1.918)	22.37 (2.078)	23.54 (2.187)
	78" (1981)	1.56 (0.145)	5.43 (0.504)	9.17 (0.852)	12.91 (1.199)	16.78 (1.559)	20.52 (1.906)	22.39 (2.080)	26.14 (2.429)	27.51 (2.555)
	84" (2134)	1.68 (0.156)	5.85 (0.543)	9.88 (0.918)	13.91 (1.292)	18.08 (1.680)	22.11 (2.054)	24.13 (2.241)	28.03 (2.604)	27.51 (2.555)
	90" (2286)	1.80 (0.167)	6.27 (0.583)	10.59 (0.984)	14.91 (1.385)	19.39 (1.801)	23.71 (2.202)	25.86 (2.403)	27.16 (2.523)	29.49 (2.739)

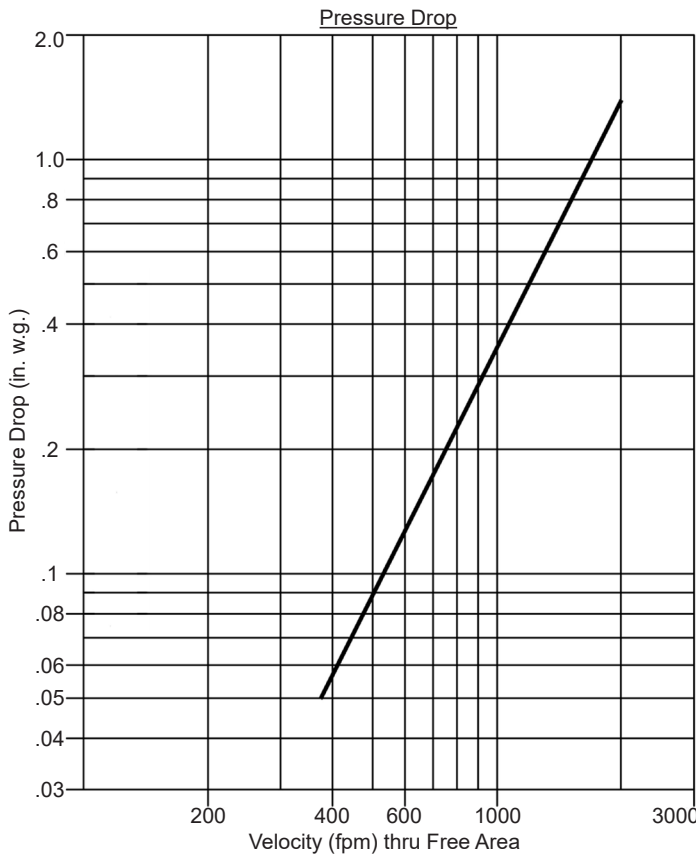

Ratings do not include the effect of a screen.  
Tests based on a 48" x 48" test size.

Fastener Schedule

Anchor Type	Substrate	Minimum Embedment	Minimum Edge Dist.
(1) ½" x 3" Red Head LDT	CMU	2½"	¾"
(1) ½" x 3" Red Head LDT	Concrete	2½"	¾"
(2) 2" x ½" Grade 5 Bolt	Steel	Full	¾"

- (1) Concrete screws shall be Red Head LDT Zinc Coated Concrete Screws.
- (2) Bolts shall be a minimum Grade 5.

Note to Occupants:

Keep occupants and mechanical equipment to a minimum of 3 feet away from Model ALCF5 louvers during severe weather events.

■ Louver Jamb Mounting Details

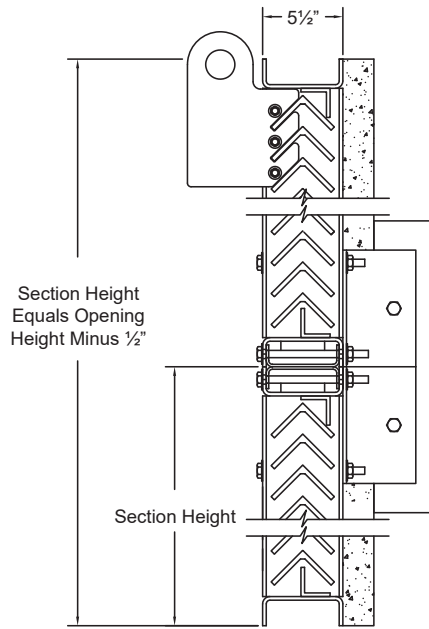

Model ALCF5  
Section View  
Recessed Frame Shown

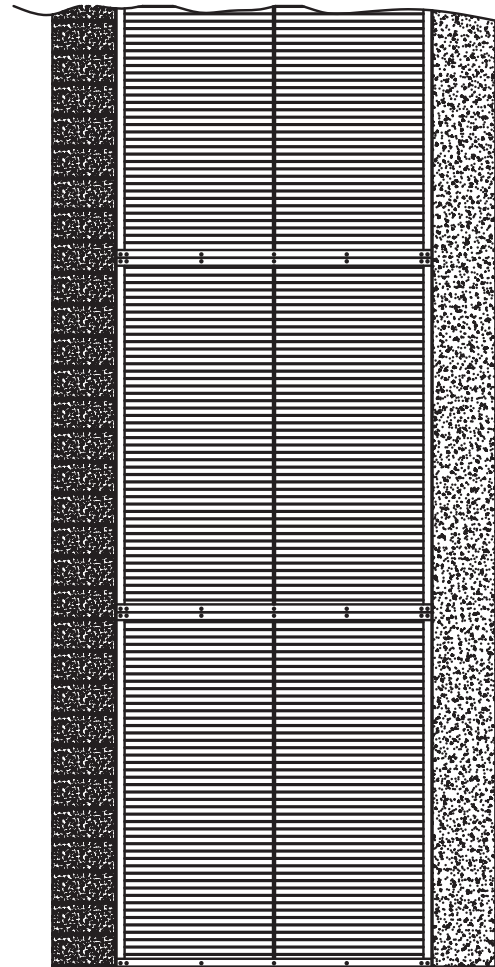

Model ALCF5  
Elevation

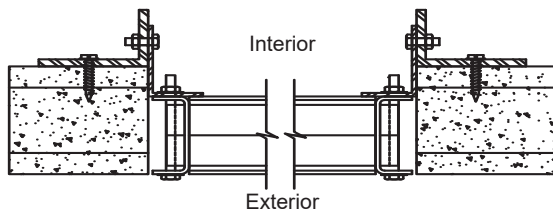

Model ALCF5  
Recessed Mount in Opening

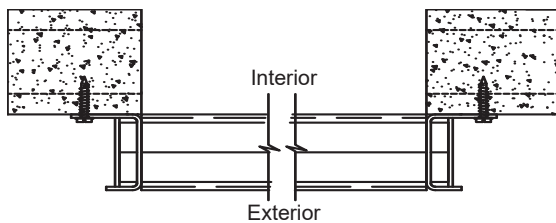

Model ALCF5  
Cantilevered at Opening

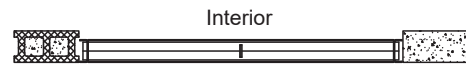

Model ALCF5  
Plan View

■ Louver Head and Sill Mounting Details

